

# D&G MULTI-FAMILY HOMES

If you want comfortable living for two families or if you want additional steady income, consider one of the multi-family plans below. All of these plans deliver two finished levels of living where each family has up to three bedrooms. And remember, on the right lot, you could add significant living space (like a playroom) in the basement level for each family. We offer many options; for instance, you can customize your multi-family home by adding a pair of rear decks, or covered front entries. And, if you have other special requirements, remember we will find a way to meet your needs.

D&G offers many multi-family homes. Check out the DONCASTER and, if the DONCASTER doesn't do it for you, browse through the other multi-family floor plans on the following pages.

D&G has the multi-family home that you are looking for.

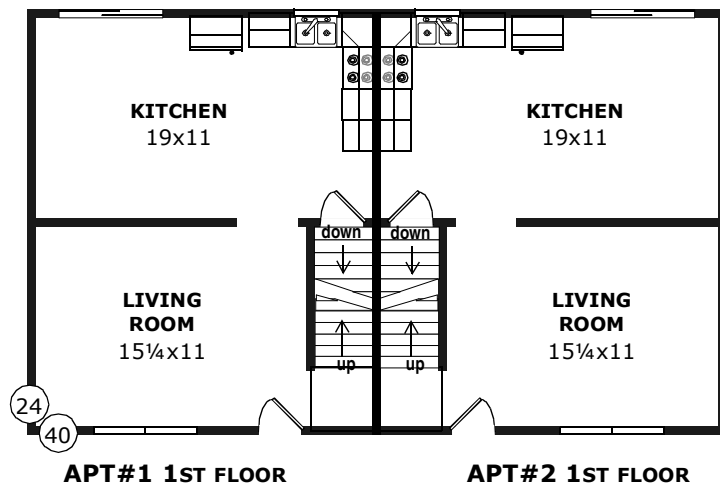
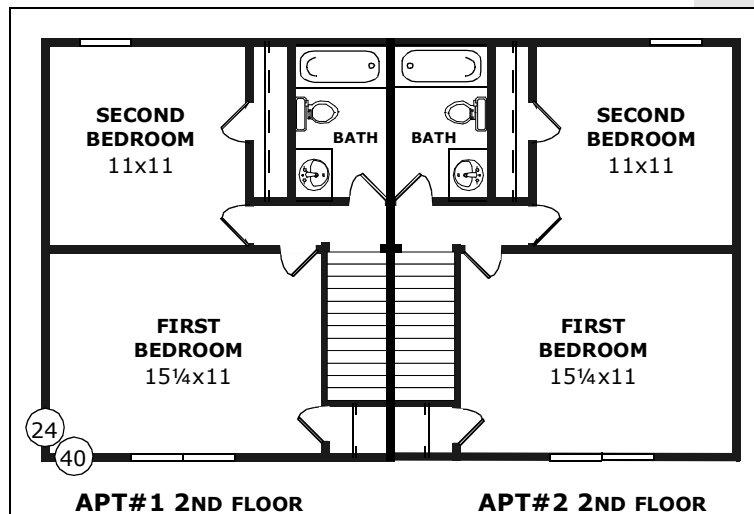
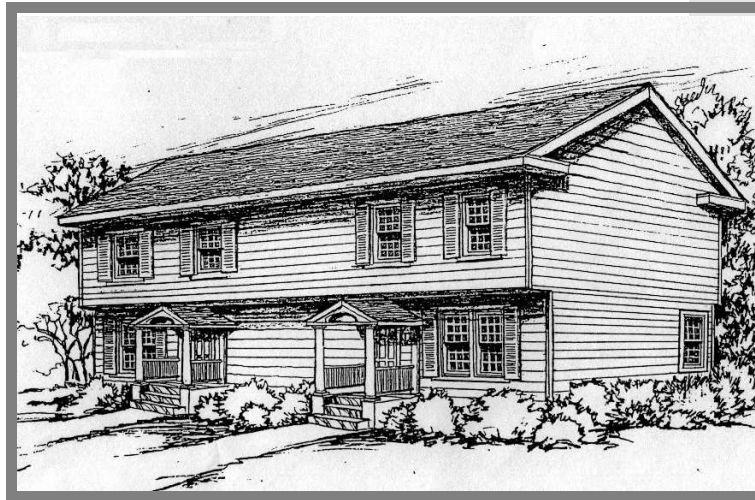

## THE DONCASTER

Good two-bedroom plan.

### D&G Multi-Family Duplex

Model Number: SD-703

Size (1st Flr): 24x40

Size (2nd Flr): 24x40

Sqft: 1920

Rooms: 4 + 4

Bedrooms: 2 + 2

Baths: 1 + 1

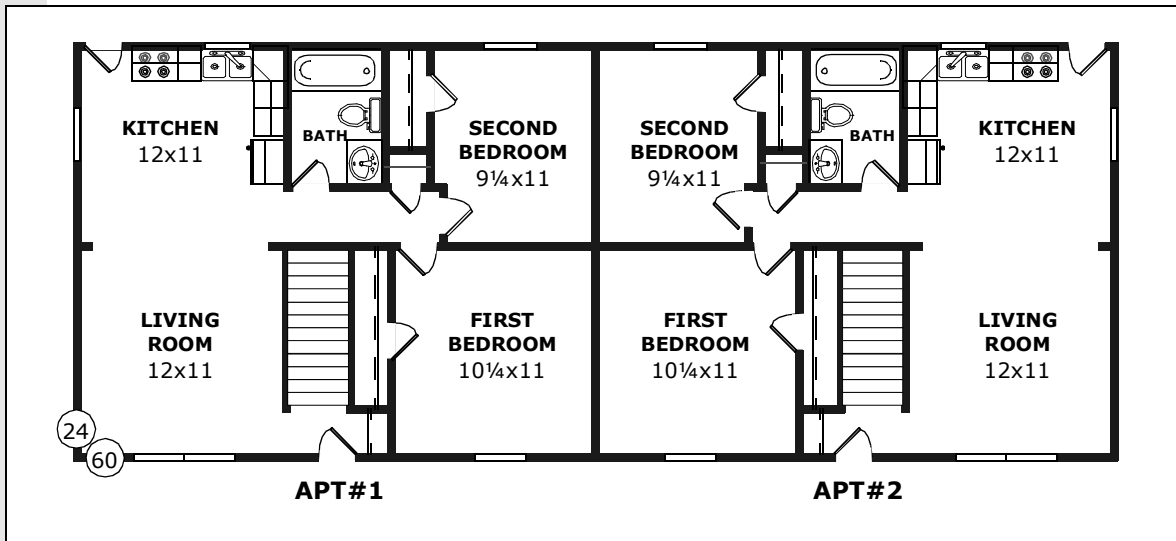

**THE CARLTON**

A little more spacious than SD-600.

**D&G Multi-Family Duplex**

Model Number: SD-601

Size: 28x60 (1680 sqft)

Rooms: 4 + 4

Bedrooms: 2 + 2

Baths: 1 + 1

**THE BRENTON**

Both apartments on the street level.

**D&G Multi-Family Duplex**

Model Number: SD-600

Size: 24x60 (1440 sqft)

Rooms: 4 + 4

Bedrooms: 2 + 2

Baths: 1 + 1

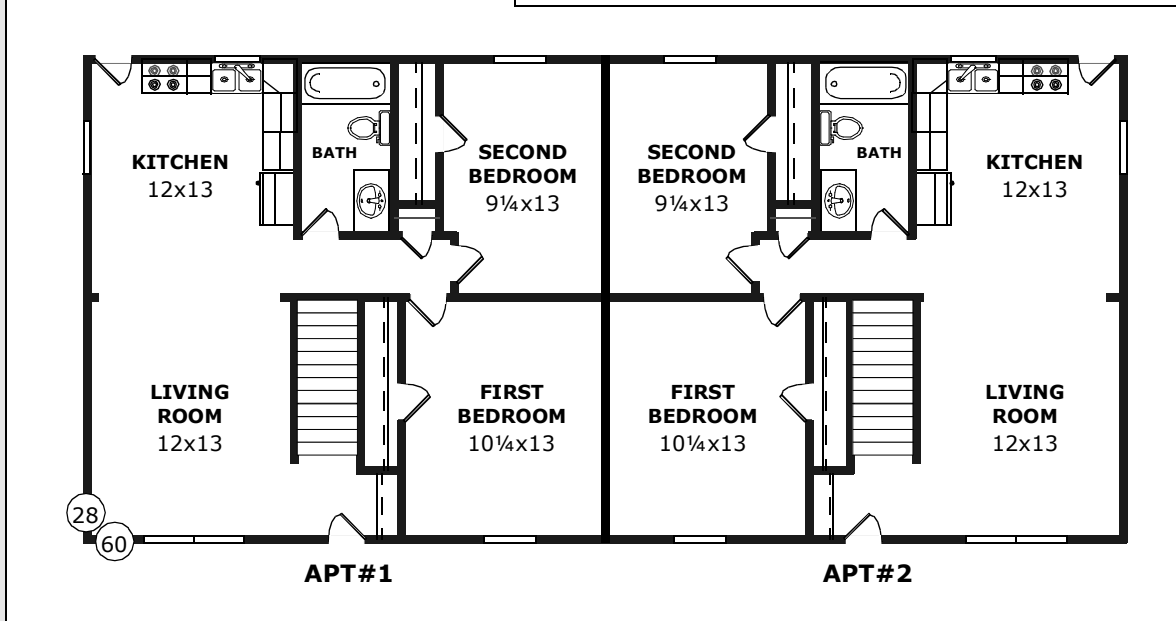

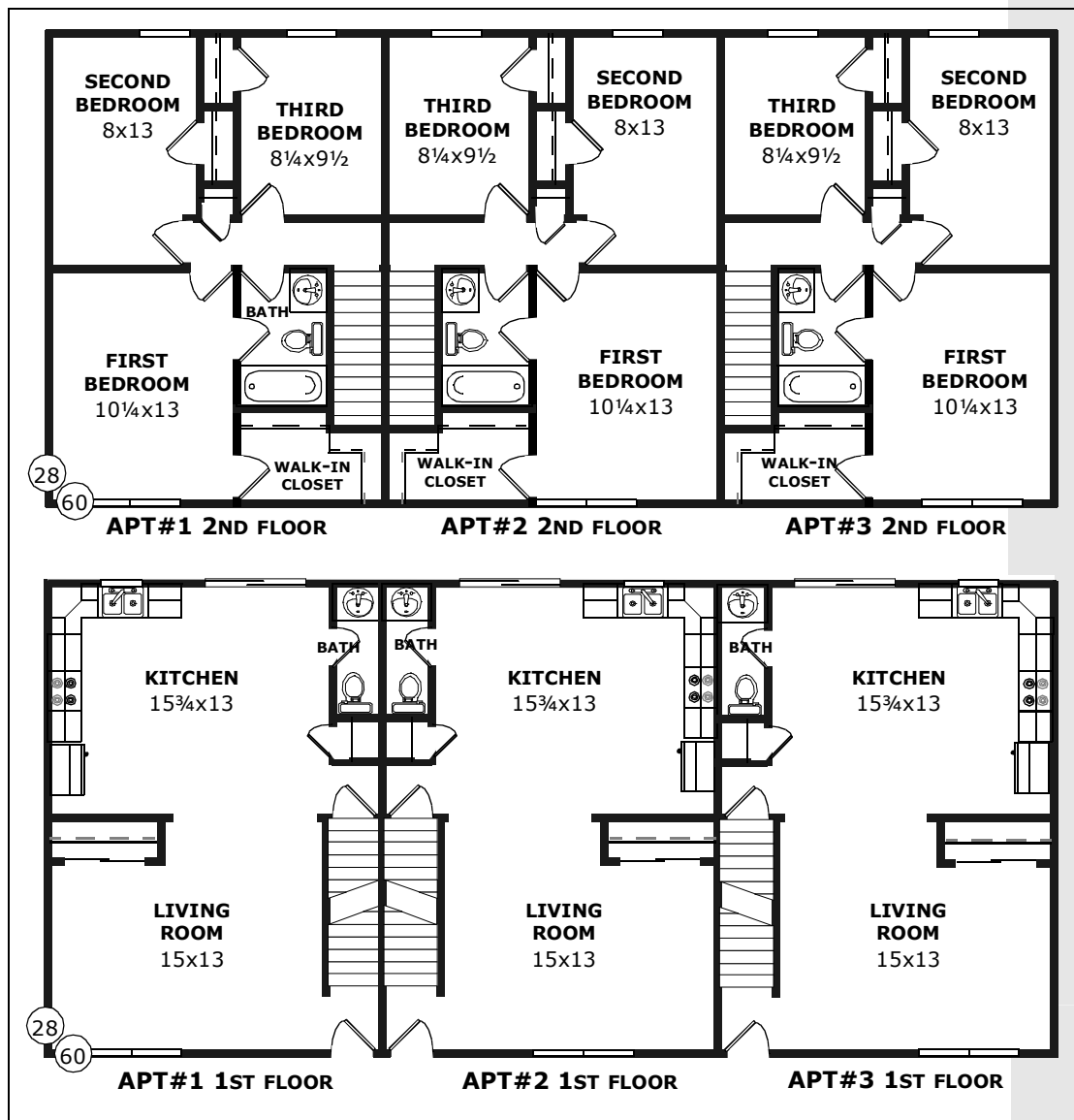

## THE SPARTAN

A free-standing single apartment of the HUNTINGTON. Multiple Spartan units can be installed in offset configurations as in the example below.

### Townhouse

Model Number: SD-505

Size (1st Flr): 28x20

Size (2nd Flr): 28x20

Sqft: 1100

Rooms: 5

Bedrooms: 3

Baths: 1½

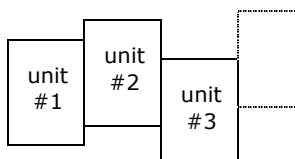

## THE HUNTINGTON

Three nice apartments each with 1100 sqft, three bedrooms, 1½ baths and the potential for a private outdoor deck/patio.

### Multi-Family Triplex

Model Number: SF-504

Size (1st Flr): 28x60

Size (2nd Flr): 28x60

Sqft: 3300

Rooms: 5 + 5 + 5

Bedrooms: 3 + 3 + 3

Baths: 1½ + 1½ + 1½

MULTI-FAMILY

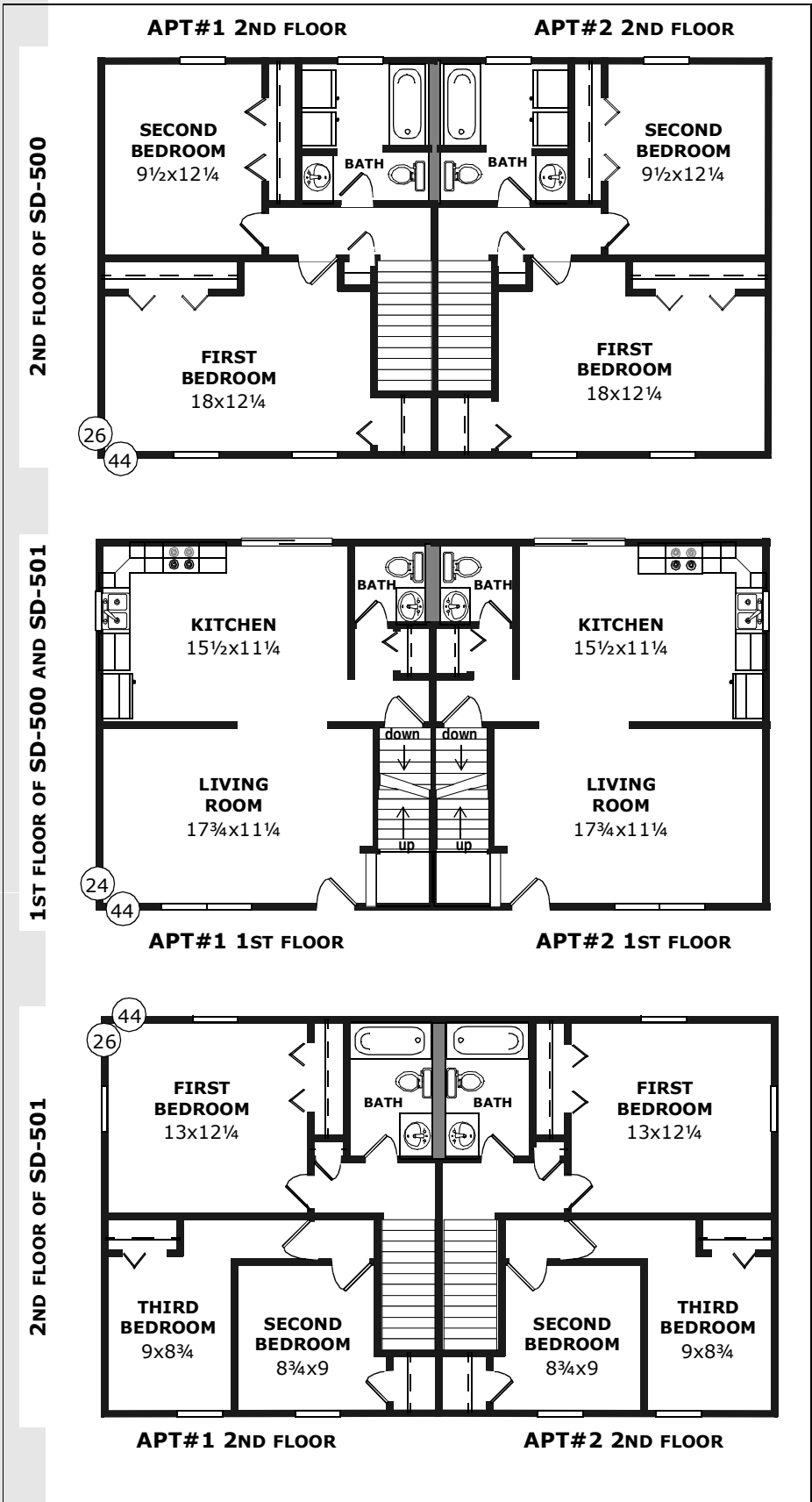

**THE ALTON**

Affordable with four big rooms in each apartment plus a bath-and-a-half and a laundry.

**D&G Multi-Family Duplex**

Model Number: SD-500

Size (1st Flr): 24x44

Size (2nd Flr): 26x44

Sqft: 2200

Rooms: 4 + 4

Bedrooms: 2 + 2

Baths: 1 1/2 + 1 1/2

**THE WESTWOOD**

A well conceived plan with three bedrooms in each apartment.

**D&G Multi-Family Duplex**

Model Number: SD-501

Size (1st Flr): 24x44

Size (2nd Flr): 26x44

Sqft: 2200

Rooms: 5 + 5

Bedrooms: 3 + 3

Baths: 1 1/2 + 1 1/2

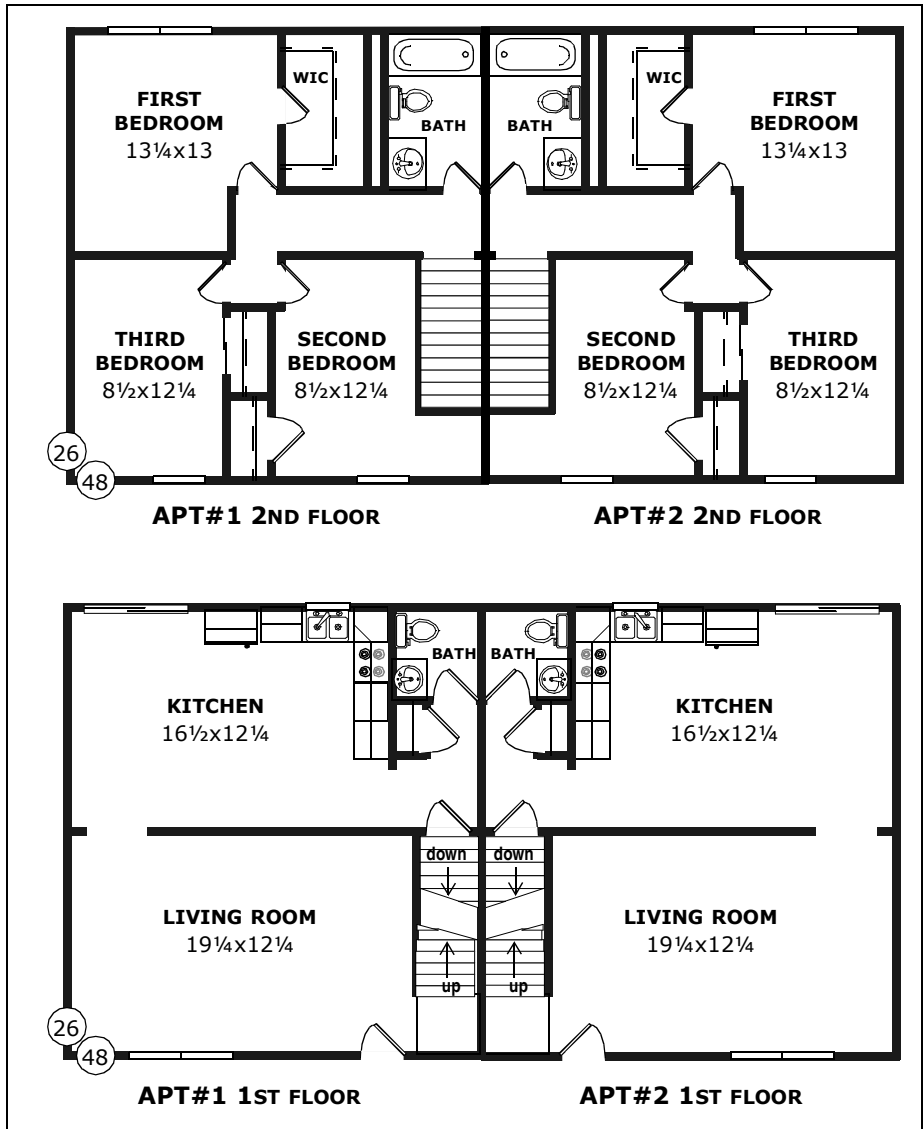

**THE GRANTHAM**

Each apartment has three nice bedrooms and large daytime rooms.

**D&G Multi-Family Duplex**

Model Number: SD-705

Size (1st Flr): 26x48

Size (2nd Flr): 26x48

Sqft: 2496

Rooms: 5 + 5

Bedrooms: 3 + 3

Baths: 1 1/2 + 1 1/2

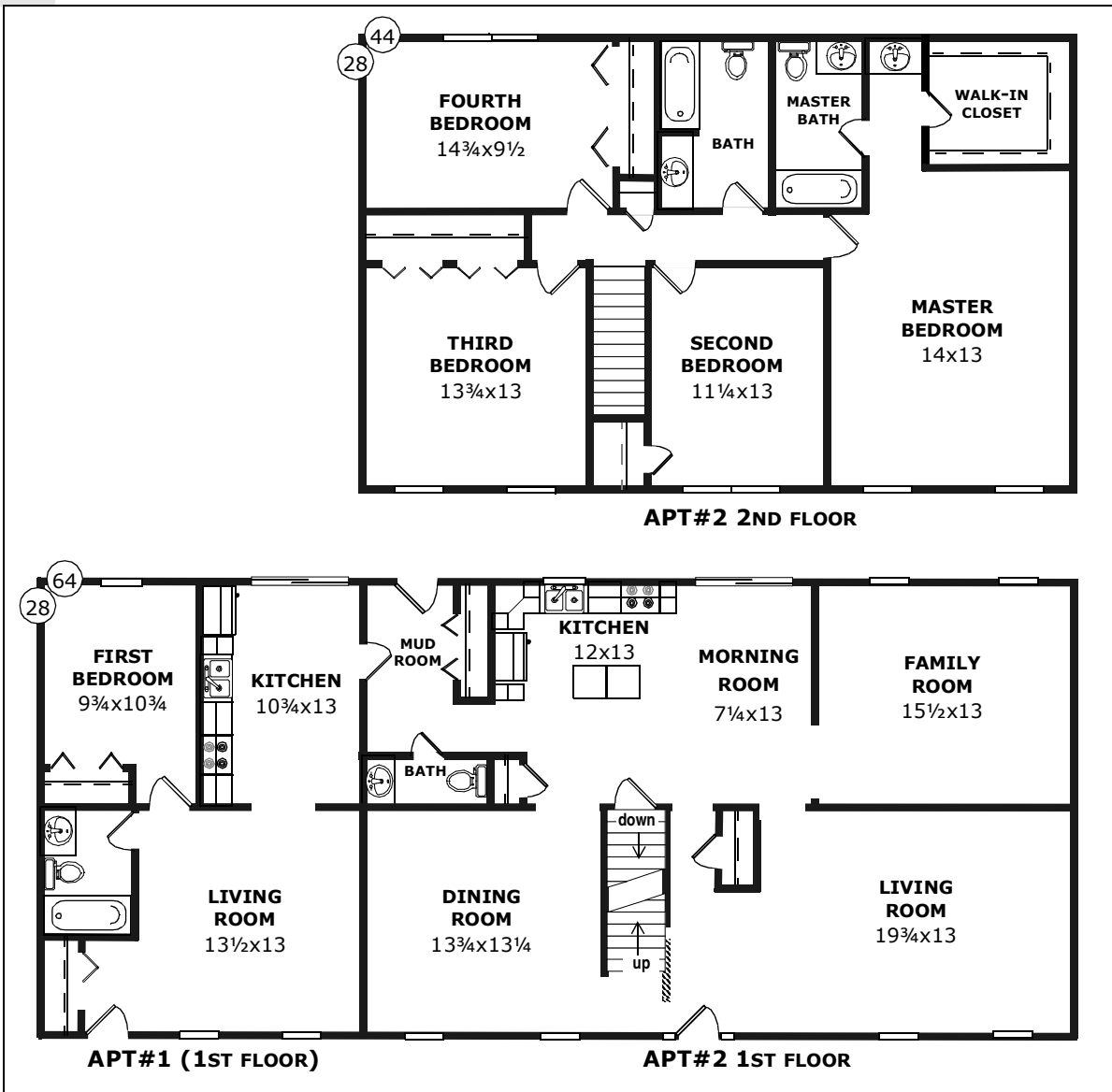

**THE YORKSHIRE**

A very spacious four-bedroom home with an attached in-law apartment.

**D&G Multi-Family In-Law**

Model Number: SD-502

Size (1st Flr): 28x64

Size (2nd Flr): 28x44

Sqft: 3024

Rooms: 3 + 8

Bedrooms: 1 + 4

Baths: 1 + 2 1/2

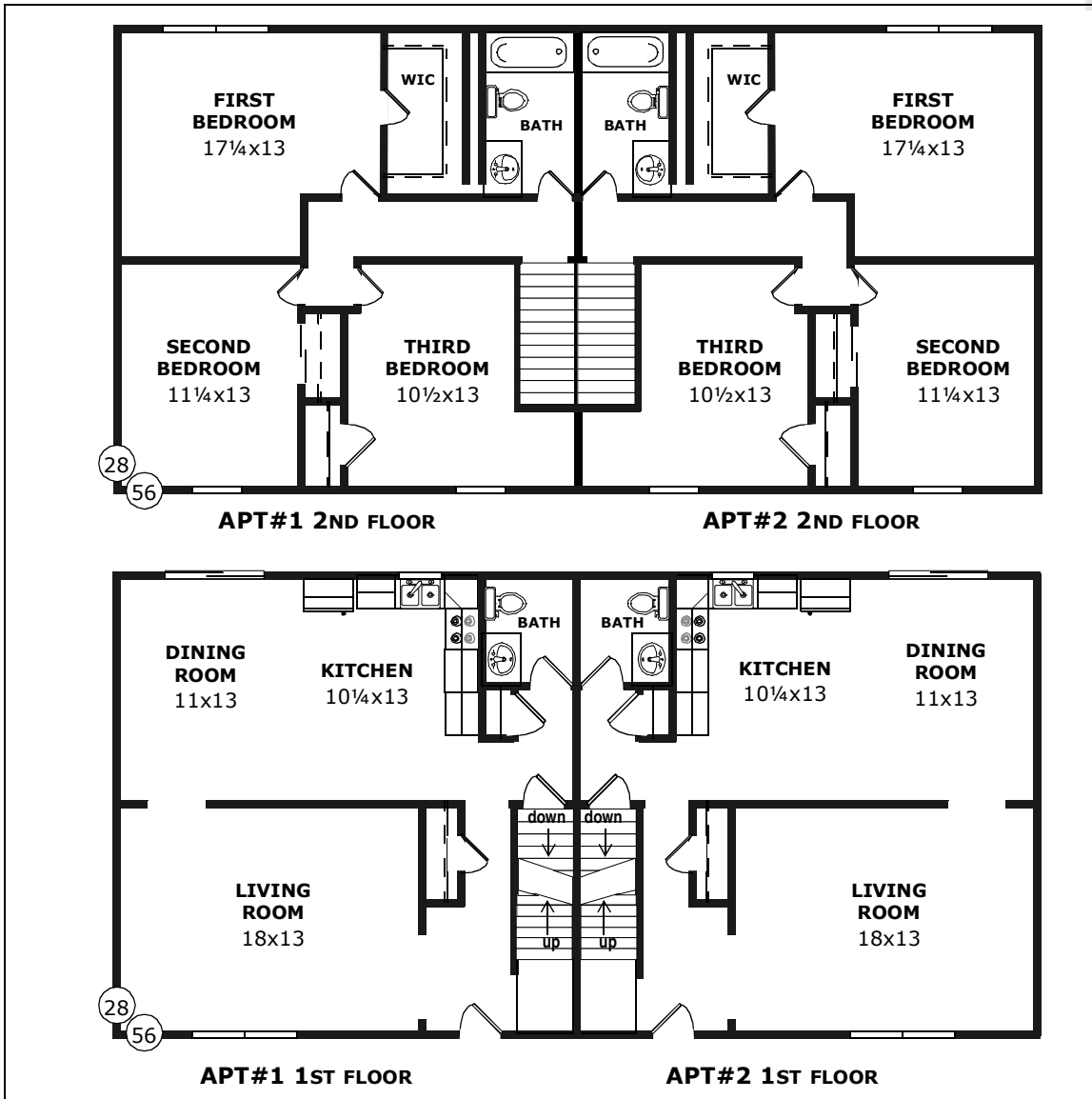

## THE SPRINGVALE

Each apartment has six nice rooms including a huge living room.

### **Multi-Family Quadplex**

Model Number: SD-706

Size (1st Flr): 28x56

Size (2nd Flr): 28x56

Sqft: 3136

Rooms: 6 + 6

Bedrooms: 3 + 3

Baths: 1½ + 1½

**MULTI-FAMILY**

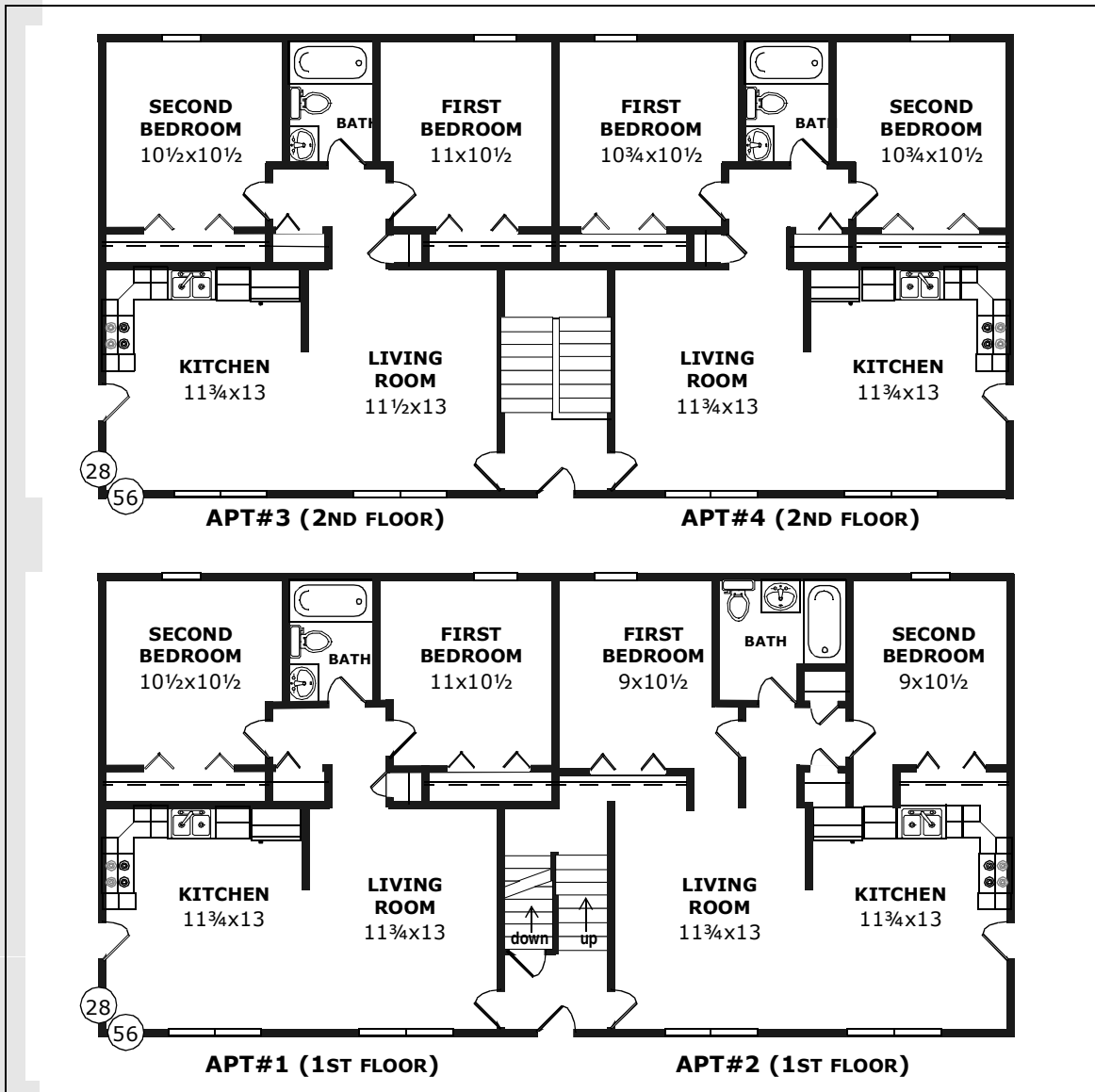

**THE HEMSTEAD**

In the right location, this could be a great income producer.

**D&G Multi-Family**

Model Number: CF-503

Size (1st Flr): 28x56

Size (2nd Flr): 28x56

Sqft: 3136

Rooms: 4 + 4 + 4 + 4

Bedrooms: 2 + 2 + 2 + 2

Baths: 1 + 1 + 1 + 1