

# CAPE MAY #309



FRONT

SITE LOCATION  
-----

STAIRS DESIGNED TO 8 1/4" RISE  
MAX., AND 9" TREAD MIN W/ 1 1/8" NOSING

Bldr/DEVEL. AUTHORIZATION	DATE	# LABEL LOCATION	<i>Gregory J. Hoyer</i> Production Engineer	<b>SUPERIOR BUILDERS</b> 1565 PA. RT. 442 E. MUNCY, PA. 17756 <b>A DIVISION OF MUNCY HOMES, INC.</b>	REV.
MANUF. AUTHORIZATION	DATE	CLG HGTH	PLANS HAVE BEEN EXTRACTED FROM APPROVED BLD'G SYSTEM DOCUMENTATION		DATABASE
		DWN BY	DATE	SCALE	
		LITZ	01-15-01	1/4"=1'-0"	309
				28X40 CAPE MAY	
				FRONT	

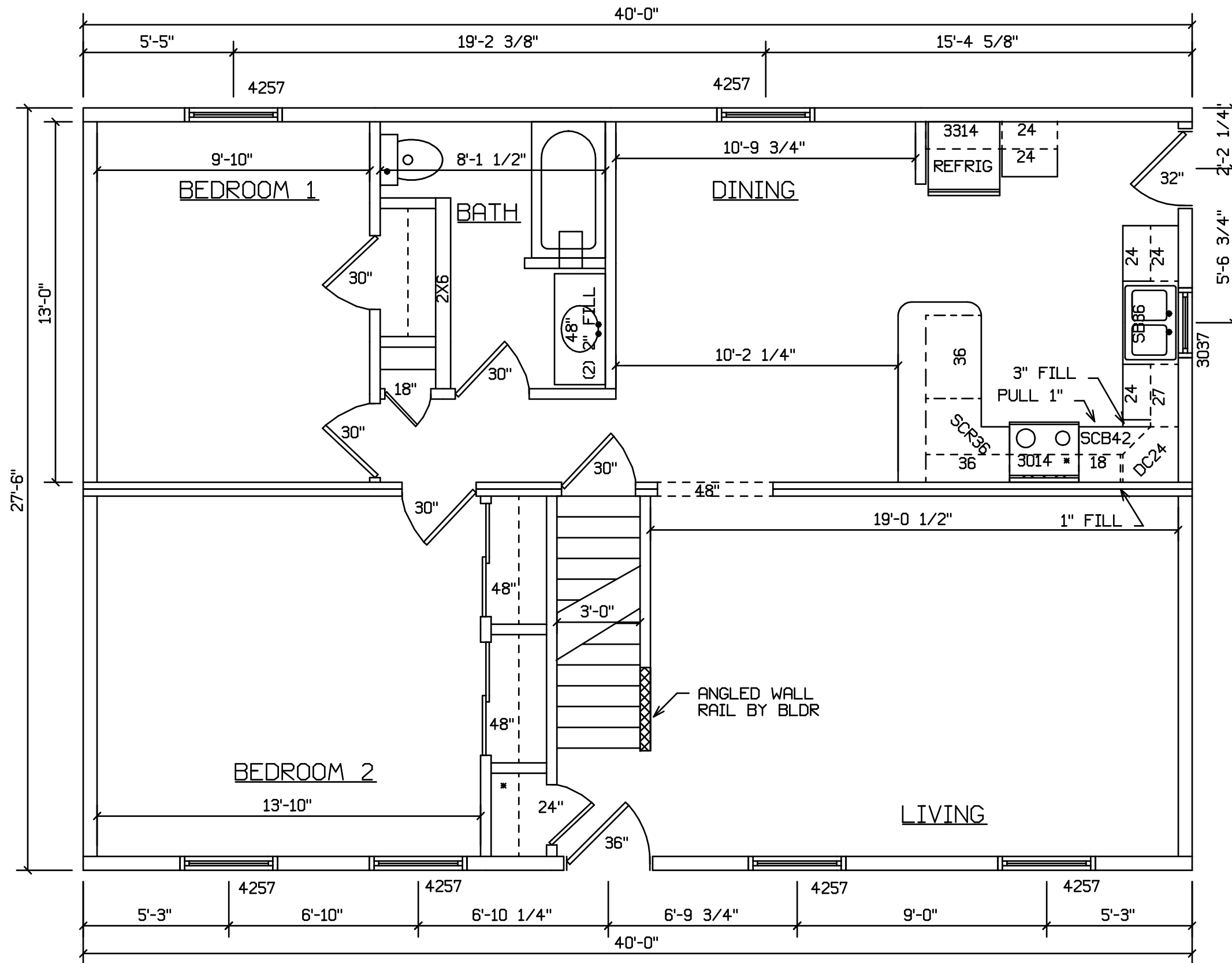

SITE LOCATION

-----

STAIRS DESIGNED TO 8 1/4" RISE  
MAX., AND 9" TREAD MIN W/ 1 1/8" NOSING

BLDR/DEVEL. AUTHORIZATION	DATE	# LABEL LOCATION	<i>Gregory J. Hayes</i> Production Engineer	<b>SUPERIOR BUILDERS</b> 1565 PA. RT. 442 E. MUNCY, PA. 17756 <b>A DIVISION OF MUNCY HOMES, INC.</b>	REV.
MANUF. AUTHORIZATION	DATE	CLG HGTH	PLANS HAVE BEEN EXTRACTED FROM APPROVED BLD'G SYSTEM DOCUMENTATION		DATABASE
		DWN BY	LITZ	28X40 CAPE MAY	
		DATE	01-15-01	FLOOR PLAN	309
		SCALE	1/4"=1'-0"		

CAPE MAY #309  
WITH OPTIONAL 60" DORMERS



FRONT

SITE LOCATION  
-----

STAIRS DESIGNED TO 8 1/4" RISE  
MAX., AND 9" TREAD MIN W/ 1 1/8" NOSING

BLDG/DEVEL. AUTHORIZATION	DATE	# LABEL LOCATION	<i>Gregory J. Hoyer</i> Production Engineer	<b>SUPERIOR BUILDERS</b> 1565 PA. RT. 442 E. MUNCY, PA. 17756 <b>A DIVISION OF MUNCY HOMES, INC.</b>	REV.
MANUF. AUTHORIZATION	DATE	PLANS HAVE BEEN EXTRACTED FROM APPROVED BLD'G SYSTEM DOCUMENTATION			DATABASE
	DWN BY	DATE	SCALE	28X40 CAPE MAY	
	LITZ	01-15-01	1/4"=1'-0"	FRONT	309