

CAPE CAMDEN #105



22'-0"

FRONT

SITE LOCATION

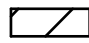
 HOLD BACK GYPBD 1'-0" PER SIDE IN OPEN AREAS
 STAIRS DESIGNED TO 8 1/4" RISE MAX., AND 9" TREAD MIN W/ 1 1/8" NOSING

| | | | | | |
|---------------------------|------|---|--|--|----------|
| BLDR/DEVEL. AUTHORIZATION | DATE | # LABEL LOCATION | <i>Gregory J. Hayes</i> Production Engineer | SUPERIOR BUILDERS 1565 PA. RT. 442 E. MUNCY, PA. 17756 A DIVISION OF MUNCY HOMES, INC. | REV. |
| MANUF. AUTHORIZATION | DATE | PLANS HAVE BEEN EXTRACTED FROM APPROVED BLDG SYSTEM DOCUMENTATION | | | DATABASE |
| | | DWN BY | DATE | SCALE | |
| | | LITZ | 8-18-99 | 1/4"=1'-0" | |
| | | | | BLDR / CUST | |
| | | | | FRONT | 105A |

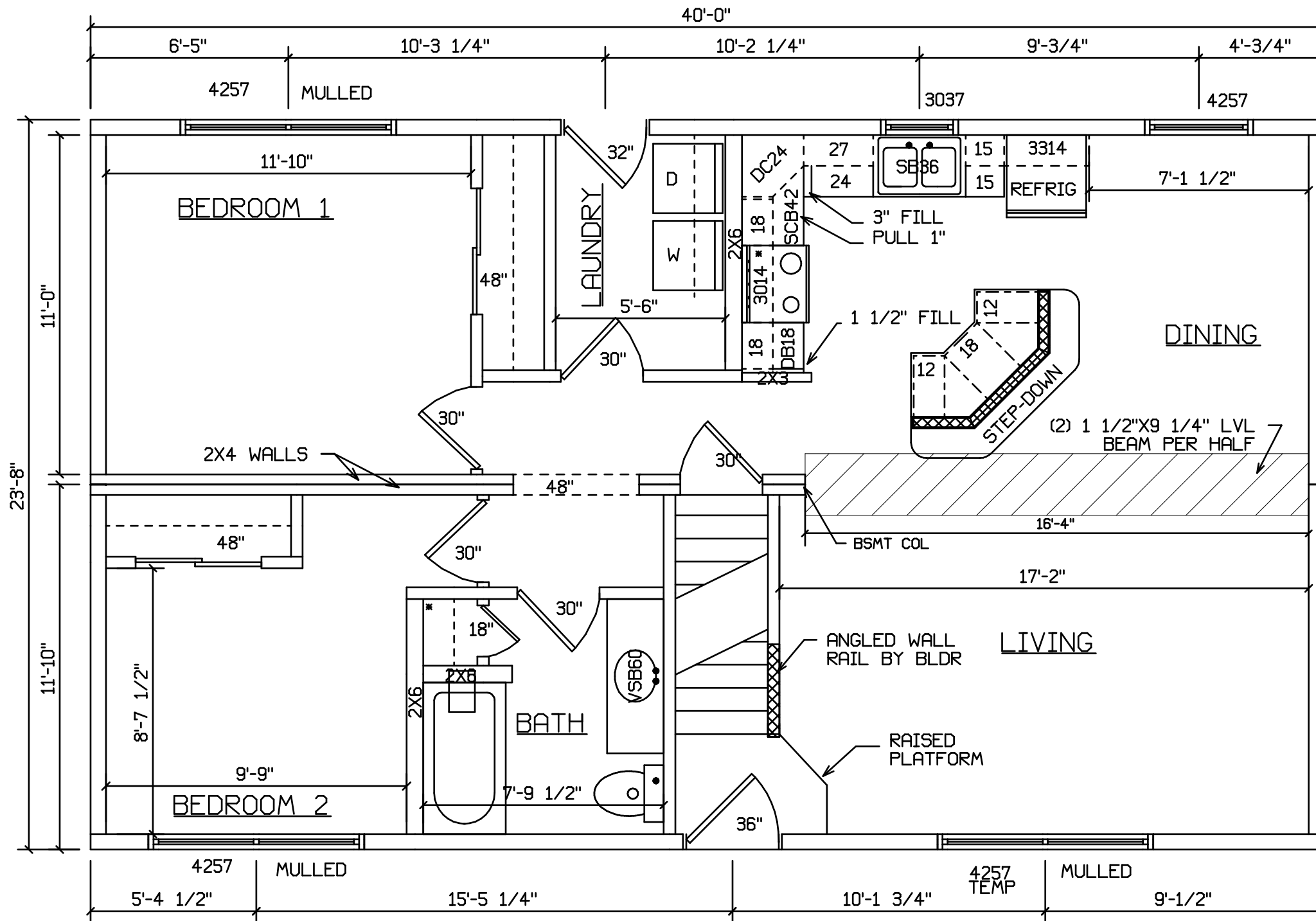

SITE LOCATION

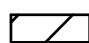
 HOLD BACK GYPBD 1'-0" PER SIDE IN OPEN AREAS

STAIRS DESIGNED TO 8 1/4" RISE MAX., AND 9" TREAD MIN W/ 1 1/8" NOSING

| | | | | | |
|---------------------------|------|------------------|---|--|-------------|
| BLDR/DEVEL. AUTHORIZATION | DATE | # LABEL LOCATION | <i>Gregory J. Hayes</i> Production Engineer | SUPERIOR BUILDERS 1565 PA. RT. 442 E. MUNCY, PA. 17756 A DIVISION OF MUNCY HOMES, INC. | REV. |
| MANUF. AUTHORIZATION | DATE | CLG HGTH | PLANS HAVE BEEN EXTRACTED FROM APPROVED BLDG SYSTEM DOCUMENTATION | | BLDR / CUST |
| | | DWN BY | DATE | SCALE | DATABASE |
| | | LITZ | 8-18-99 | 1/4"=1'-0" | FLOOR PLAN |
| | | | | | 105A |

CAPE CAMDEN #105
WITH OPTIONAL 60" DORMERS



FRONT

SITE LOCATION

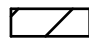
 HOLD BACK GYPBD 1'-0" PER SIDE IN OPEN AREAS
STAIRS DESIGNED TO 8 1/4" RISE MAX., AND 9" TREAD MIN W/ 1 1/8" NOSING

| | | | | | |
|---------------------------|------|------------------|---|--|----------|
| BLDR/DEVEL. AUTHORIZATION | DATE | # LABEL LOCATION | <i>Gregory J. Hayes</i> Production Engineer | SUPERIOR BUILDERS 1565 PA. RT. 442 E. MUNCY, PA. 17756 A DIVISION OF MUNCY HOMES, INC. | REV. |
| MANUF. AUTHORIZATION | DATE | CLG HGTH | PLANS HAVE BEEN EXTRACTED FROM APPROVED BLDG SYSTEM DOCUMENTATION | | DATABASE |
| | | DWN BY | DATE | SCALE | |
| | | LITZ | 8-18-99 | 1/4"=1'-0" | |
| | | | | BLDR / CUST | |
| | | | | FRONT | 105A |