

PLAN NO. 798



SITE LOCATION

 HOLD BACK GYPBD 1'-0" PER SIDE IN OPEN AREAS
 STAIRS DESIGNED TO 7 3/4" RISE MAX., AND 10" TREAD MIN W/ 1 1/8" NOSING

BLDR/DEVEL. AUTHORIZATION	DATE	# LABEL LOCATION	<i>Superior Builders</i> Production Engineer	SUPERIOR BUILDERS 1565 PA. RT. 442 E. MUNCY, PA. 17756 A DIVISION OF MUNCY HOMES, INC.	REV.
MANUF. AUTHORIZATION	DATE	CLG H6TH	PLANS HAVE BEEN EXTRACTED FROM APPROVED BLDG SYSTEM DOCUMENTATION DWN BY LITZ DATE 12-24-01 SCALE 1/4"=1'-0"		BLDR /CUST 26/28X44 2 STORY DUPLEX

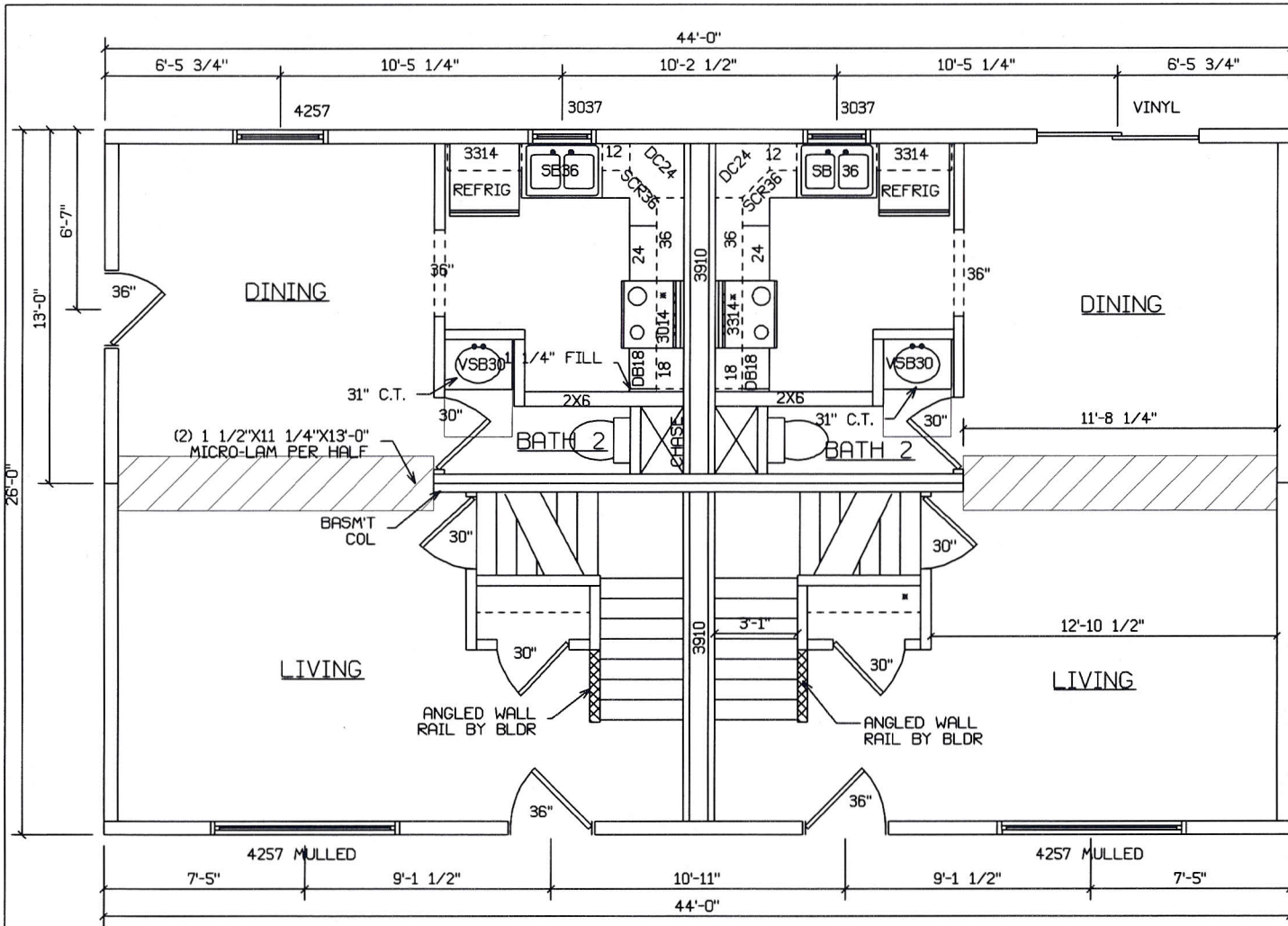

SITE LOCATION

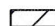
 HOLD BACK GYPBD 1'-0" PER SIDE IN OPEN AREAS

STAIRS DESIGNED TO 7 3/4" RISE MAX., AND 10" TREAD MIN W/ 1 1/8" NOSING

BLDR/DEVEL. AUTHORIZATION	DATE	"LABEL LOCATION"	<i>Superior Builders</i>	REV.
		CLG H6TH	<i>Production Engineer</i>	
PLANS HAVE BEEN EXTRACTED FROM APPROVED BLDG SYSTEM DOCUMENTATION				
MANUF. AUTHORIZATION	DATE	DWN BY	SCALE	DATE
		LITZ	12-24-01 1/4"=1'-0"	26/28X44 2 STORY DUPLEX
SUPERIOR BUILDERS 1565 PA. RT. 442 E. MUNCY, PA. 17756 A DIVISION OF MUNCY HOMES, INC.			BLDR /CUST	DATABASE 798

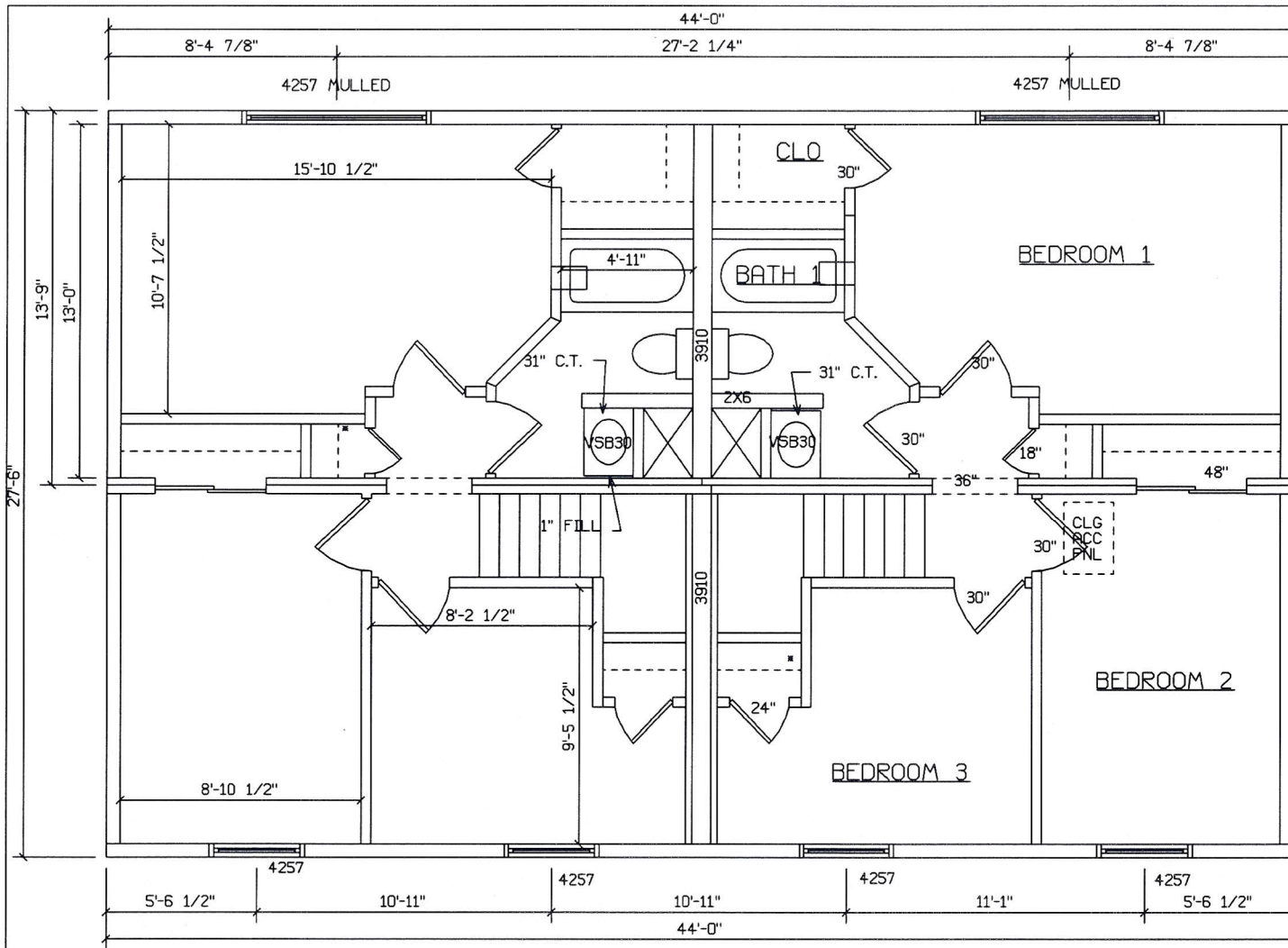

THIS LEVEL OVERHANGS THE LOWER BY 9" FRONT AND REAR. ITS THE BLDRS RESPONSIBILITY TO INSULATE AND INSTALL SOFFIT MATERIAL ON SITE

SITE LOCATION

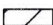
 HOLD BACK GYPBD 1'-0" PER SIDE IN OPEN AREAS
STAIRS DESIGNED TO 7 3/4" RISE MAX., AND 10" TREAD MIN W/ 1 1/8" NOSING

BLDR/DEVEL. AUTHORIZATION	DATE	# LABEL LOCATION	<i>Superior Builders</i> Production Engineer	SUPERIOR BUILDERS 1565 PA. RT. 442 E. MUNCY, PA. 17756 A DIVISION OF MUNCY HOMES, INC.	REV.			
	DATE	CLG H6TH	PLANS HAVE BEEN EXTRACTED FROM APPROVED BLDG SYSTEM DOCUMENTATION		BLDR /CUST	DATABASE 798		
MANUF. AUTHORIZATION	DATE	DWN BY	LITZ	DATE	12-24-01	SCALE	1/4"=1'-0"	26/28X44 2 STORY DUPLEX